



GRAND
MAJESTIC 
Galapagos Cruise

GRAND MAJESTIC LUXURY GALAPAGOS ISLANDS YACHT



The Grand Majestic is perfect for small sophisticated groups to travel in style with excellent onboard service. It is specially designed for exclusive high end private charters. The guide, captain and crew are dedicated to providing the highest quality service.

- ✓ *Ideal for private charters*
- ✓ *Large master suite available*
- ✓ *Excellent itineraries*
- ✓ *High -Quality service*

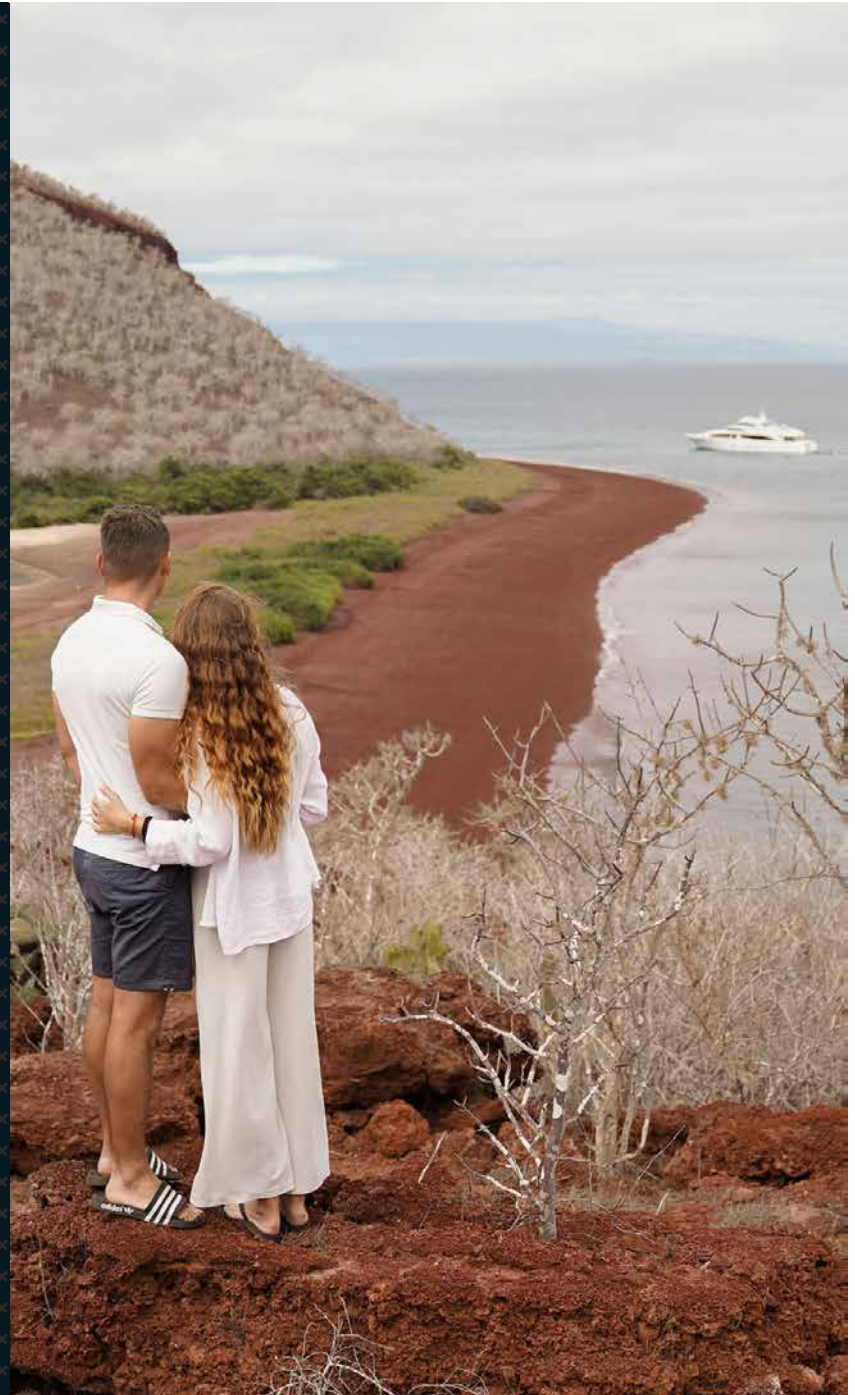



MAIN DECK MASTER SUITE (x1)

- Area 420 ft² / 39 m²
- 1 King Size bed
- TV and DVD in the room
- His and Her bathrooms
- Panoramic windows



MAIN DECK STATEROOM (x1)

- Area 132 ft² / 12 m²
- 2 Twin Beds (can be converted into California King Size)
- TV and DVD in the room
- Panoramic windows





LOWER DECK STATEROOM (x6)

- Area 170ft² / 16m² (cabins 1 & 2), 181ft² / 17m² (cabins 3 to 6)
- 1 King Size bed + sofa bed
- TV and DVD in the room
- Porthole windows



GRAND MAJESTIC YACHT TECHNICAL SPECIFICATIONS

CONSTRUCTION	2018
TYPE	USA Designed motor yacht
LENGTH	127' (39 m)
BEAM	24' (7.30 m)
DRAFT	5' 11" (1.80 m)
SPEED	25 knots (fastest yacht in Galapagos)
CAPACITY	16 passengers
MAIN ENGINES	MTU Series 2000 - 2400HP
WATER MAKER	2 X 1200 Gallons / day
EXTERIOR	Naval Aluminium, GFRP
CREW	9 members + 1 Naturalist Bilingual Guide

- ACCOMMODATION**
- **Lower Deck:** 6 Staterooms
 - **Main Deck:** 1 Stateroom, 1 Master Suite with his and her bathrooms
 - **Sun Deck:** Jacuzzi
- *All cabins with private bathrooms, hot water and air-conditioning.

SAFETY & NAVIGATION

- Furuno Tz touch multifuncion radar
- Furuno 1815 radar
- Gps GP39
- Epirb ACR global fixV4
- 2x Icom M324G Vhf with DSC radios
- Icom M8020Hf DSC radio
- Furuno FCV628 depth sounder
- OSC-30 Satellite Compass
- ABC extintors
- CO2 bank
- 2x 25-man life raft
- 2x ACR bidirectional radios
- Sart ACR Pathfinder Pro
- SIMRAD A2004 Autopilot
- DMS Hunter

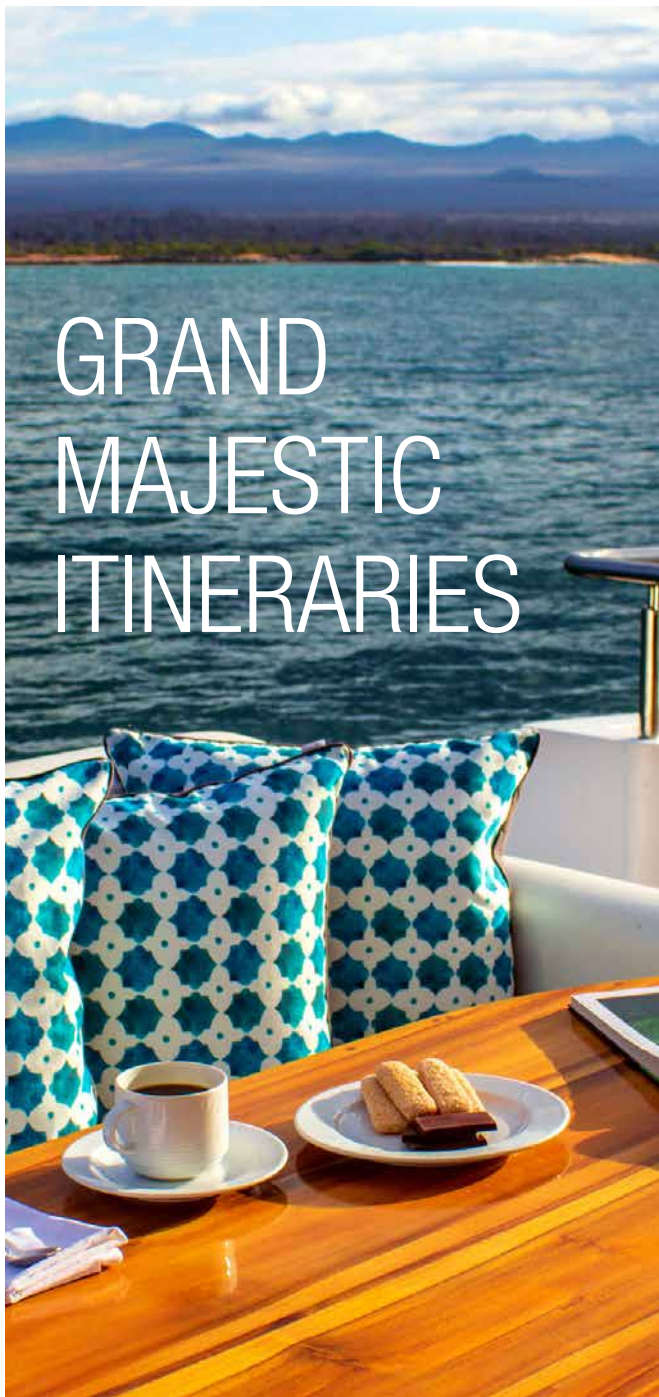

GRAND MAJESTIC ITINERARIES

8 DAY CRUISE (A)

Mon	am pm	San Cristobal Airport: Arrival. Transfer to boat San Cristobal: El Junco Lagoon
Tue	am pm	Floreana: Post Office Bay/Baroness Viewing Point Floreana: Cormorant Point/ Devil's Crown
Wed	am pm	Española: Suarez Point Española: Gardner Islet/Osborn Islet/Gardner Bay
Thu	am pm	Santa Cruz: Twin Craters Santa Cruz: Interpretation Center Fausto Llerena
Fri	am pm	Genovesa: El Barranco Genovesa: Darwin Bay
Sat	am pm	Rabida Island: Rabida Chinese Hat Islet
Sun	am pm	San Cristobal: Witch Hill San Cristobal: Lobos Island

4 DAY CRUISE

5 DAY CRUISE

8 DAY CRUISE (B)

Mon	am pm	San Cristobal: Interpretation Center San Cristobal: Breeding Center David Rodriguez
Tue	am pm	North Seymour Island Santa Cruz Island: Black Turtle Cove
Wed	am pm	Bartholomew Island: Bartholomew Santiago: Egas Port
Thu	am pm	Isabela: Tagus Cove Isabela: Urbina Bay
Fri	am pm	Fernandina: Espinosa Point Isabela: Vicente Roca Point
Sat	am pm	Santiago: Buccaneer Cove / Espumilla Beach Santiago: Sullivan Bay
Sun	am pm	Santa Cruz: Bachas Beach Santa Cruz: Interpretation Center Fausto Llerena
Mon	am pm	San Cristobal: Kicker Rock San Cristobal: Transfer to San Cristobal Airport

8 DAY CRUISE (B)



8-Day Cruise "A"

Monday - Monday



8-Day Cruise "B"

Monday - Monday



4-Day Cruise

Monday - Thursday



5-Day Cruise

Thursday - Monday

● Arrival ● Visitor Site ● Departure ✈ Airport

*Itineraries subject to change without previous notice.

GRAND MAJESTIC DECKPLANS

LOWER DECK

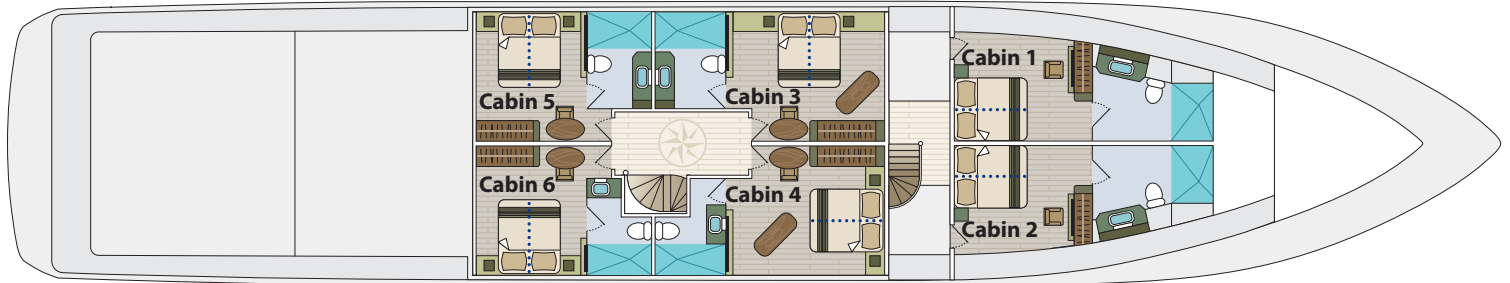

MAIN DECK

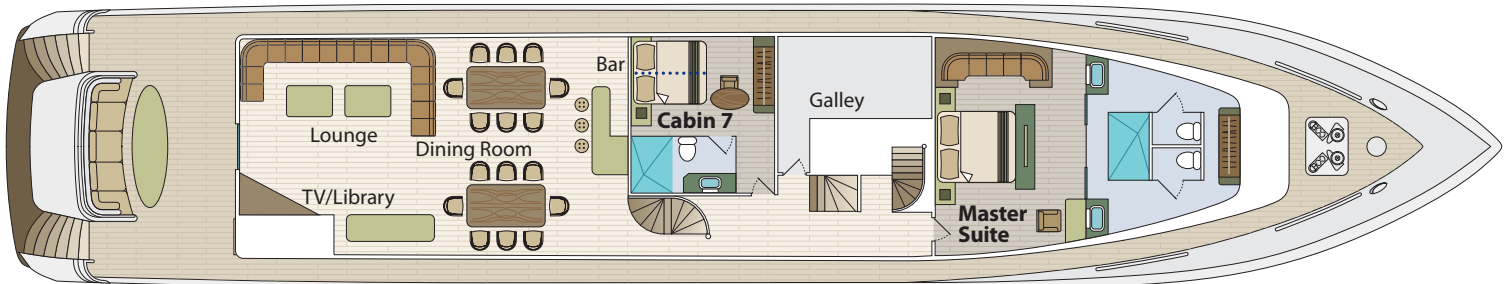

SUNDECK

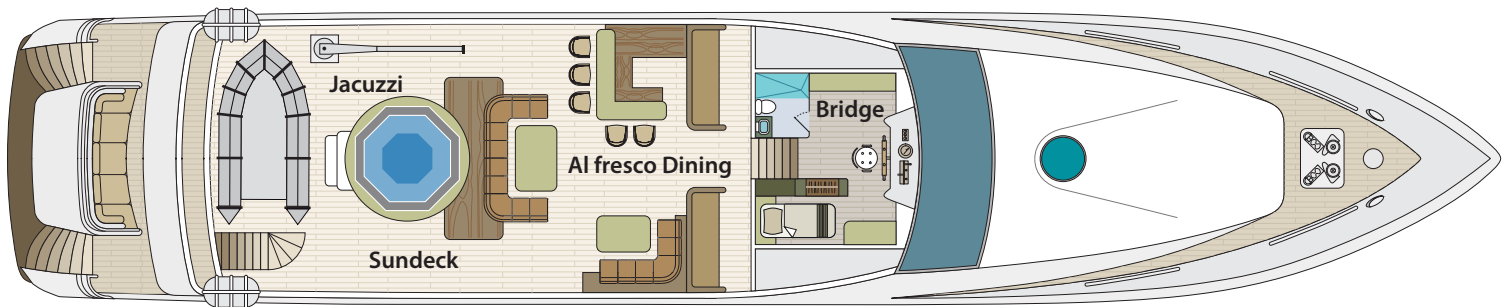

 Escape routes are posted in each cabin. Please take the time to review these carefully.





G R A N D
MAJESTIC 
Galapagos Cruise

www.grandmajestic-cruise.com